

# SAM





,



# 操作手冊

1	.....	5
1.1	.....	5
1.2	.....	5
1.3	.....	5
1.4	.....	7
1.5	.....	7
2	.....	7
2.1	.....	7
2.2	.....	7
2.3	.....	7
2.4	.....	8
3	.....	9
3.1	.....	9
3.2	.....	9
3.3	.....	9
3.4	.....	10
4	.....	11
4.1	.....	11
4.2	.....	11
4.3	.....	11
4.4	.....	11
4.5	.....	12
4.6	.....	12
4.7	.....	15
5	.....	16



# 操作手冊

## 1

### 1.1

SAM-285 SAM-440 SAM-700

SAM-440-08 SAM

440

L/min 08



:

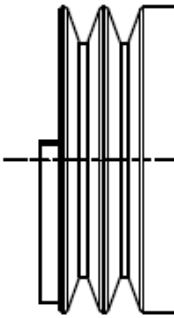

V

DIN7753 PART1 / ISO 4184

ISO 1940-G6.3 VDI2060-Q6.3 ISO 8821







操作手冊

3

3.1

" " 3HP 30HP " "

1

SAM-440

SAM-700



3.2

3.3

2

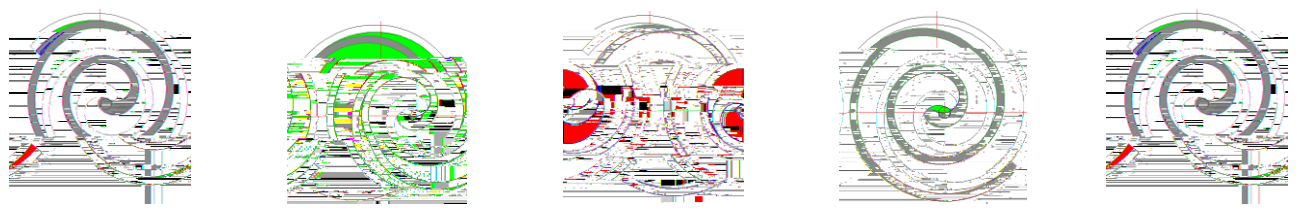

3.4

Oil-free scroll air end technical data

Model	Shaft power	Rated pressure	Air displacement	Exhaust interface	Speed	Noise value	Outline size	Weight
	KW	Mpa	L/min	inch	r/min	dB(A)	mm	kg
SAM-285	2.2	0.8	250	PT3/8"	2840	64	270x300x265	15.5
	2.4	1.0	215		2400			
SAM-440	3.75	0.8	410	PT1/2"	3050	65	347x330x295	19.5
	4.4	1.0	355		3000			
SAM-700	5.5	0.8	570	PT3/4"	2950	66	335x381x357	31.5
	6.0	1.0	490		2650			



4.

4.1

±



## 4.5



## 4.6



		500	2500	5000	10000	15000	20000	
		2		2	4	6	8	
								3500h
								2500h
								6



		500	2500	5000	10000	15000	20000	
		2		2	4	6	8	
								2500h





**QUANIELLO**  
**INTERNO**

